

A modern dining room with a long wooden table, black leather chairs, and a large window. The room features dark grey walls, a white ceiling with a gold chandelier, and a fireplace with a round mirror above it. The floor is made of light-colored wood.

THE ADDRESS

CITYWEST

Let's
meet here?



**Excellence has
a new Address**

Safety First

The Address Citywest offers superb spacious Meeting and Events spaces that have now been adapted to meet the challenges of Covid-19. We are committed to providing excellent service to our meeting delegates & event guests in a safe environment.

Our "Safety Program" focuses on the health and safety of our guests, delegates and employees. Our spacious meeting and event spaces ensure social distancing is fully observed and supported by additional safety protocols.

Our maximum capacities have been reduced to enable social distancing between delegates and adhere to the safety guidelines provided by the HSE.

Some of these measures include:

- Hand sanitising stations have been installed in all meeting rooms.
- Visual aids have been installed in restrooms and public areas to remind delegates of best hand hygiene practice, respiratory hygiene and cough etiquette.
- All meeting spaces are deep cleaned and sanitisation of all touch points including door handles, lift buttons, hand rails, meeting room equipment, cables, glass water bottles, pencils and light switches.
- We ask that attendees sanitise their hands as often as needed to ensure maximum safety.
- We ensure the practice of social distancing in all public areas and help organisers to safely usher delegates to their meeting room.
- We actively remind our clients of the importance of communicating personal responsibility for self-distancing when in their meeting space.
- We keep a contact register of all meeting delegates.
- We ask that delegates do not attend a meeting if they have a high temperature or are feeling unwell.

The Lodge

unique | intimate | vintage | rustic



This is something very special, a two-storey, circa 300-year-old Georgian building that has been re-designed in sympathy with the beautiful style and heritage of its time.

This was once home to the Irish tenor Josef Locke whose name and creativity lives on in the inspiration for this event space.

Each room of the house has been tastefully curated as a unique event space, going beyond all modern in-room technologies that you expect, these rooms have a functioning fireplace to add real atmosphere to any event.

There are 6 event spaces in the house that accommodate up to 120 delegates (60 with social distancing), outside The Lodge is a Secret Garden where outdoor events can be enjoyed all year round.

Meet
in person



hear what they didn't
say

understand what they
didn't mean

meet who you didn't
expect





Gallery

| Gallery | | Location | m | | | ft | | |
|-----------|----------|-----------|---------|---------|---------|---------|-----------|-----------|
| | | | Length | Width | Area | Length | Width | Area |
| | | Level 2 | 5 | 10 | 47 | 15 | 34 | 510 |
| Room Hire | | Boardroom | U-Shape | Banquet | Cabaret | Theatre | Reception | Classroom |
| Full Day | Half Day | 15 | 18 | - | - | 40 | 80 | 20 |
| €280 | €240 | | | | | | | |

Josef Locke Library

| | | m | | | ft | | |
|----------|-----------|---------|---------|---------|---------|-----------|-----------|
| Location | | Length | Width | Area | Length | Width | Area |
| Level 2 | | 4 | 5 | 24 | 15 | 18 | 261 |
| | Boardroom | U-Shape | Banquet | Cabaret | Theatre | Reception | Classroom |
| | 12 | - | - | - | - | - | - |

Garden Room

| | | m | | | ft | | |
|-----------|--|---------|---------|---------|---------|-----------|-----------|
| Location | | Length | Width | Area | Length | Width | Area |
| Level 2 | | 5 | 10 | 47 | 15 | 34 | 510 |
| Boardroom | | U-Shape | Banquet | Cabaret | Theatre | Reception | Classroom |
| 15 | | 18 | 40 | 30 | 40 | 80 | 20 |

Drawing Room

| | m | | | ft | | |
|----------|-----------|---------|---------|---------|---------|---------------------|
| Location | Length | Width | Area | Length | Width | Area |
| Level 2 | 7 | 10 | 69 | 22 | 34 | 748 |
| | Boardroom | U-Shape | Banquet | Cabaret | Theatre | Reception Classroom |
| | 12 | 18 | - | - | 25 | 70 15 |

KingsWood Suite

| | m | | | ft | | | |
|----------|-----------|---------|---------|---------|---------|-----------|-----------|
| Location | Length | Width | Area | Length | Width | Area | |
| Level 2 | 10 | 15 | 153 | 33 | 50 | 1,650 | |
| | Boardroom | U-Shape | Banquet | Cabaret | Theatre | Reception | Classroom |
| | 30 | 40 | 110 | 70 | 120 | 120 | 60 |

Authors Lounge

| | m | | | ft | | | |
|----------|-----------|---------|---------|---------|---------|-----------|-----------|
| Location | Length | Width | Area | Length | Width | Area | |
| Level 2 | 4 | 5 | 24 | 15 | 18 | 261 | |
| | Boardroom | U-Shape | Banquet | Cabaret | Theatre | Reception | Classroom |
| 12 | - | - | - | - | - | - | - |

The Lodge



The Lodge

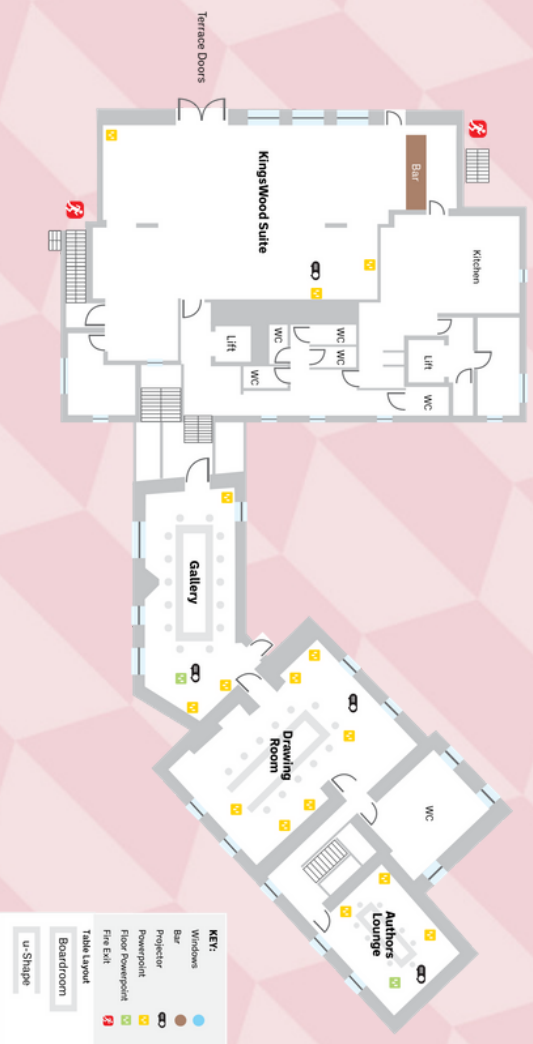



From our Cookhouse

All our event dishes come from McGettigans Cookhouse & Bar.
Built on a proven track record creates and delivers great tasting food using fresh quality ingredients sourced from artisan local suppliers and served with professional standards of service and hospitality.



Breaks

Tea and Coffee

Tea, Coffee and Biscuits

Tea, Coffee and Scones served with Jam and Cream

Classic Breakfast

Full Irish breakfast with Tea and Coffee

Deluxe Breakfast

Full Irish breakfast with Tea, Coffee, Pastries and Fruit

Lunch

Sandwiches with Tea and Coffee

Soup and Sandwiches with Tea and Coffee

Main Course with Tea and Coffee

2 Courses with Tea and Coffee



3 Course

Starter

Soup of the Day

Served with fresh sourdough bread

Crispy Chicken Wings

House made hot sauce served with a blue cheese dip

Caesar Salad

Baby gem, croutons, crispy bacon, grana

Main Course

Roast Chicken au Jus

Half roast chicken with root veg, creamy mash potato

Baked Fillet of Salmon

With tomato & basil mash, chargrilled courgette and a citrus hollandaise sauce

Roast Striploin of Irish Beef

Served with creamy mash, seasonal veg & gravy

All our main courses are served
with fresh market vegetables & boiled baby potatoes

Desserts

Cookhouse Crumble with Vanilla bean ice-cream

Warm Chocolate Brownie with vanilla bean ice cream and chocolate sauce

Freshly brewed tea or coffee



Soup Course

Fresh Homemade Soup of the Day

Served with rustic bread

Appetizer

Knockdrinna Goats Cheese Salad

Rocket leaves, balsamic reduction, sundried tomato,
pine-nuts topped with rich Knockdrinna Goats cheese

Atlantic Smoked Salmon

Smoked salmon, capers, walnuts, marinated fennel & dill sauce

Chicken Caesar Salad

Baby gem, croutons, crispy bacon, grana

Main Course

8oz Sirloin of Dry Aged Irish Hereford Beef

Roasted shallot, mushroom confit & red wine jus

Roast Chicken au Jus

Roasted carrots & parsnips & red wine jus

Pan-Fried Fillet of Salmon

Sun-dried tomato mash, charred courgette & a citrus hollandaise sauce

All our main courses are served with fresh market vegetables
& boiled baby potatoes

Desserts

Rich Chocolate Mousse, Chantilly cream & orange segment

Crème Brûlée, Caramel glass & fresh cream

Apple, Plum & Strawberry Crumble Served with vanilla bean ice cream

Freshly brewed tea or coffee

4 Course



BBQ

8oz Home Made-Beef Burger

Lettuce, pickle, tomato, onion, smoked applewood cheese, chipotle mayonnaise on a brioche bun

Chargrilled Chicken Burger

Lettuce, tomato, lemon aioli, onion on a brioche bun

Gourmet Sausages or Hot Dogs

Irish pork sausages with herbs and spices or

2oz Frankfurter sausage served in a brioche bun

Minute Steak

Cooked to order

Salad Selections

- Greek Feta Salad
- Superfood Salad
- Corn on the Cob
- Salt Baked Potatoes

Sweet Temptations

Pancakes & Selection of Ice creams

Make a Splash

Chilled Glasses of Prosecco

Add some punch

Pitcher of Summer Punch

A wooden cutting board with a knife and fresh produce. The knife has a black handle and a silver blade. In the bottom left corner, there are red grapes. In the bottom right corner, there are yellow and green bell peppers.

Buffet

Starters

Soup of the Day
Caesar Salad with garlic croutons
Greek Salad with feta cheese, mixed leaves and olives
Niçoise Salad
Superfood Salad with beetroot, broccoli, feta cheese and walnuts

Main Courses

Pork Chops with a spicy mustard sauce and Thai coconut curry sauce
Roast chicken au jus with red wine jus
Roast sliced beef striploin served with pepper sauce
Seafood or Cottage pie topped with mozzarella cheese

Sides & Salads

Sautéed
chorizo and baby potatoes
Fresh market vegetables
Savoury rice
Spicy chunky chips

Assiette of Deserts

Freshly brewed Tea & Coffee

A wooden cutting board with a knife and fruit. The knife has a black handle and a silver blade, positioned at the top left. In the bottom left corner, there are red grapes. In the bottom right corner, there are yellow lemons and a green lime. The text 'Canapé' is written in white on a dark grey banner in the top right corner.

Canapé

McGettigan's Mini Sliders
Chicken or beef

Prawns Tempura Chicken Skewers
Curry, satay or chilli

Chicken Liver Parfait on toast

Salmon Mousse Bruschetta

Vegetarian spring rolls

A place
to sleep

For those in need of a

good bed, a cold drink

& big fluffy towels





Our location

Kingswood Village
Citywest
Dublin D22W580
Ireland.





The Address Citywest is located in KingsWood village just off **exit 2** on the **M7 Naas road** in Dublin 22.

The hotel is just 15 minutes walk from the Luas light rail red line which takes you to **Dublin city centre in 30 minutes**.

The Address Citywest is:

- 24 km from Dublin Airport
- 9 km from Dublin city centre
- Within close proximity to many business parks
- Within close proximity to the M50 motorway

theaddresscitywest.com 353(0)1 461 9900

sales.citywest@theaddresscollective.com



THE
ADDRESS
CITYWEST

**An Address
like no other**

the**address**citywest.com 353(0)1 461 9900

Connolly • Citywest • Cork

